

Circleg Transtibial Cosmetic Cover

1

Measure and adjust

The cosmetic cover should fit tightly on the lower edge of the knee, leaving a 10mm gap between the lower end of the cosmetic cover and the upper edge of the foot cover.

Measure the cover and cut it while assembled with a cutter if needed. Use a cutter to curve the upper cut-out of the cover so that it fits perfectly around the socket.

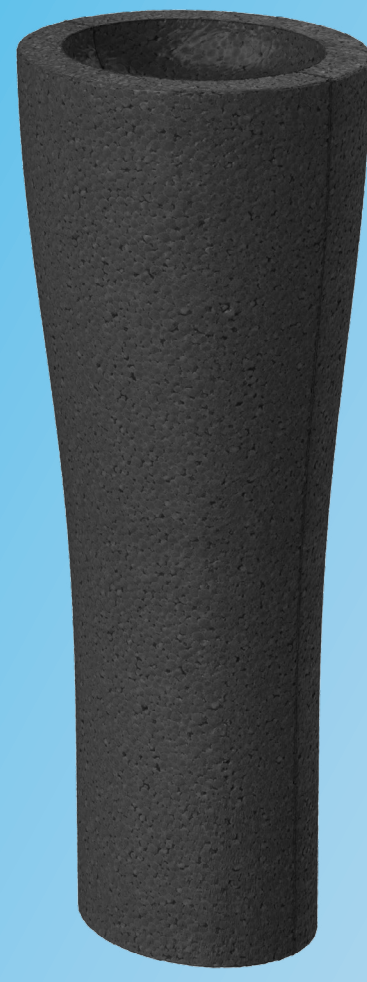

CC1-TT



Cutter



2

Assemble and customize

Take one half of the cosmetic cover, apply glue to the surface, and place it on the socket. Repeat the same procedure with the second half.

Use sandpaper to smoothen the transition from the cover to the socket. Customize the appearance with artificial leather or colored wrappings if desired.



Scan the code to get the instruction video!

circleg.world
sales@circleg.world
support@circleg.world

IP-CC1-TT-EN V01 REV00

circleg