

# Product Catalogue 2023



**circleg**

**When functionality,  
affordability and  
aesthetics merge.**

Circleg Product  
Catalogue 2023

CAT01b  
V03  
November 2023

Circleg AG  
Rautistrasse 30  
8047 Zürich  
Switzerland

Circleg Prosthetics Ltd  
40B Peponi Road  
Nairobi  
Kenya

[www.circleg.world](http://www.circleg.world)  
[sales@circleg.world](mailto:sales@circleg.world)

**circleg**





# Welcome to the World of Circleg

The Circleg prosthetic system is a high quality, modular, functional, aesthetic and affordable prosthetic leg for above and below-knee amputees. It was developed by an interdisciplinary team of Swiss and East African designer, engineers and economists, in collaboration with amputees and P&O professionals. The objective was to create a prosthetic system that prioritizes quality, comfort, aesthetics, adherence to the highest prosthetic standards, all while remaining affordable for those in need. In addition, our system streamlines the fitting process with easy and rapid adjustment options, requiring only simple tools and no additional infrastructure. It seamlessly integrates with other systems and locally sourced components, ensuring accessibility and compatibility.

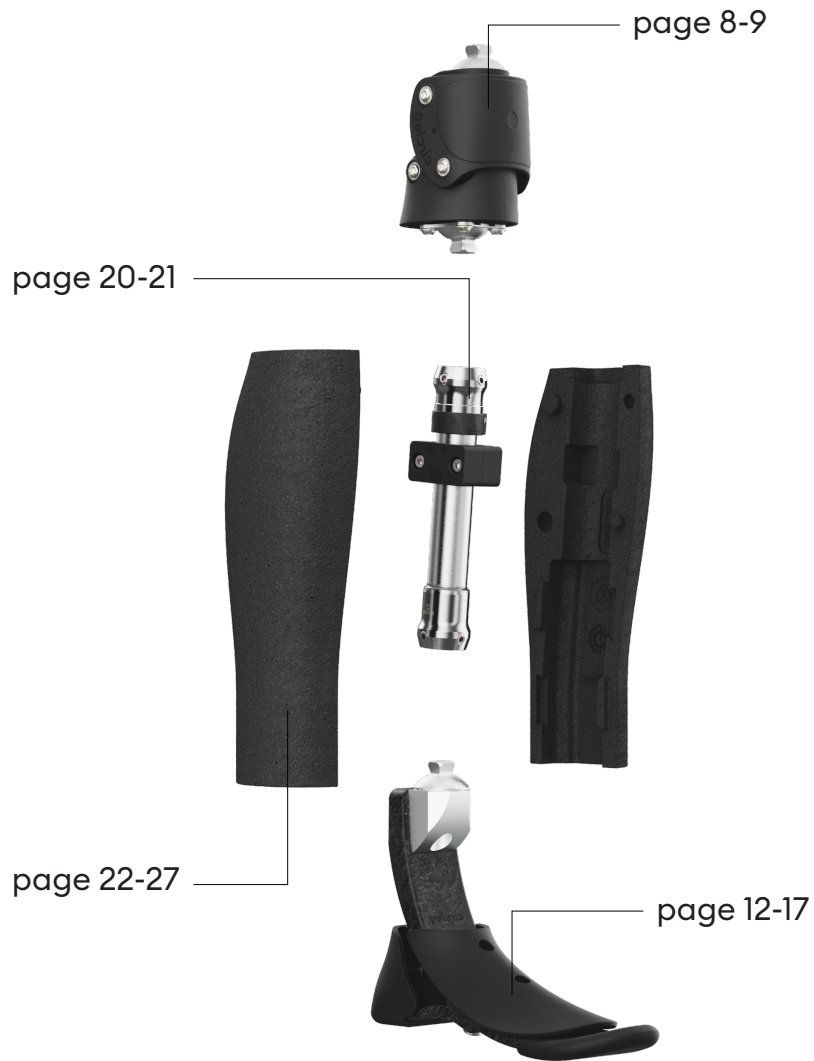

page	content
<b>8</b>	<b>Polycentric Knee</b>
<b>12</b>	<b>Dynamic Foot S</b>
<b>14</b>	<b>Dynamic Foot M</b>
<b>16</b>	<b>Dynamic Foot L</b>
<b>20</b>	<b>Pylon Kit</b>
<b>22</b>	<b>Cosmetic Cover TF<sup>1</sup> SM</b>
<b>24</b>	<b>Cosmetic Cover TF<sup>1</sup> ML</b>
<b>26</b>	<b>Cosmetic Cover TT<sup>2</sup></b>
<b>28</b>	<b>How to order</b>

1 TF: transfemoral or above-knee  
 2 TT: transtibial or below-knee



# Circleg One

## Polycentric Knee

PK1



## Stability and Comfort

The Circleg Polycentric Knee provides a high level of stability at heel strike and additional ground clearance during the swing phase. It includes an extension assist spring and a flexion damper to optimize energy consumption and gait cycle. The knee allows for flexion of up to 150°. The mechanism is protected from dust and dirt by a knee cap, which also enables an aesthetic natural shape when in a sitting position.

<b>Mobility Grade</b>	K2-K3
<b>Distal Connection</b>	Pyramid Adapter
<b>Proximal Connection</b>	Pyramid Adapter
<b>Knee Flexion Angle</b>	150°
<b>Component Height (mm)</b>	150
<b>Component Weight (g)</b>	870
<b>Maximal Body weight (kg)</b>	100



**The Circleg feels  
stable and secure,  
I like it!**

**- Samuel Musana**

# Circleg One

## Dynamic Foot S

F1-S-KIT



## Energy and Durability

The Circleg Dynamic Foot S is designed for active users with increased durability and desired energy storage/return. It provides for a smooth roll-over during stance phase. The plastic-fibreglass material is lightweight yet durable and, combined with the design, provides a natural, comfortable feel during activities. The foot can easily be adjusted to the foot sizes 21 to 24 cm. The innovative cover design protects the foot from moisture and dirt, while allowing for seamless left & right customization based on required orientation of the foot. It is designed to withstand a maximal body weight of 60kg.

<b>Mobility Grade</b>	K2-K3
<b>Side</b>	left & right
<b>Size (cm)</b>	21-24
<b>Maximal Body Weight (kg)</b>	60
<b>Component Height (mm)</b>	200
<b>Component Weight (g)</b>	880



# Circleg One

## Dynamic Foot M

F1-M-KIT



## Energy and Durability

The Circleg Dynamic Foot M is designed for active users with increased durability and desired energy storage/return. It provides for a smooth roll-over during stance phase. The plastic-fibreglass material is lightweight yet durable and, combined with the design, provides a natural, comfortable feel during activities. The foot can easily be adjusted to the foot sizes 24 to 27 cm. The innovative cover design protects the foot from moisture and dirt, while allowing for seamless left & right customization based on required orientation of the foot. It is designed to withstand a maximal body weight of 80kg.

<b>Mobility Grade</b>	K2-K3
<b>Side</b>	left & right
<b>Size (cm)</b>	24-27
<b>Maximal Body Weight (kg)</b>	80
<b>Component Height (mm)</b>	200
<b>Component Weight (g)</b>	977

# Circleg One

## Dynamic Foot L

F1-L-KIT



## Energy and Durability

The Circleg Dynamic Foot L is designed for active users with increased durability and desired energy storage/return. It provides for a smooth roll-over during stance phase. The plastic-fibreglass material is lightweight yet durable and, combined with the design, provides a natural, comfortable feel during activities. The foot can easily be adjusted to the foot sizes 27 to 30 cm. The innovative cover design protects the foot from moisture and dirt, while allowing for seamless left & right customization based on required orientation of the foot. It is designed to withstand a maximal body weight of 100kg.

<b>Mobility Grade</b>	K2-K3
<b>Side</b>	left & right
<b>Size (cm)</b>	27-30
<b>Maximal Body Weight (kg)</b>	100
<b>Component Height (mm)</b>	200
<b>Component Weight (g)</b>	1060

**The Circleg makes me  
feel confident –  
I don't have to pretend  
to be who I am not.**

**- Sarah Ngugi**





# Circleg One Pylon Kit

PS1-KIT



## Modularity and Adjustability

The Pylon Kit includes a 250 mm long aluminium pylon, a stainless steel female adapter and a stainless steel clamp adapter. It is laid out for a maximal body weight of 100kg and can be cut to adjust to the different needs of the users.

<b>Length (mm)</b>	250
<b>Maximal Body Weight (kg)</b>	100
<b>Diameter (mm)</b>	30

# Circleg One

## Cosmetic Cover TF SM

CC1-TF-SM-KIT



### Lightweight and Customizable

The Circleg Cosmetic Cover TF<sup>1</sup> SM is designed for transfemoral (above-knee) amputees and gives the Circleg its unique look. The cover provides a natural leg shape and maximum protection for your prosthesis. The lightweight material is impact, water and chemical resistant and can be adjusted in length and shape to suit the individual user. The size SM is designed for body sizes of up to 170 cm. The cover also serves as an ideal base for customized leather or textile wrappings. With its simple clamp system, it can be fitted quickly, minimizing the labor time required for the cosmetic finish.

Length (mm)	250-310
Weight (g)	129
Body size (cm)	150-170

<sup>1</sup> TF: transfemoral or above-knee

# Circleg One

## Cosmetic Cover TF ML

CC1-TF-ML-KIT

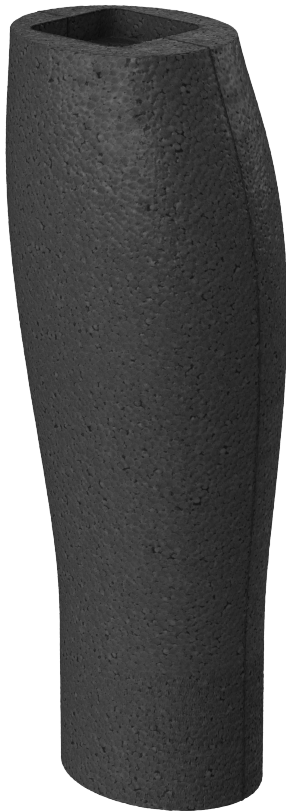

### Lightweight and Customizable

The Circleg Cosmetic Cover TF<sup>1</sup> ML is designed for transfemoral (above-knee) amputees and gives the Circleg its unique look. The cover provides a natural leg shape and maximum protection for your prosthesis. The lightweight material is impact, water and chemical resistant and can be adjusted in length and shape to suit the individual user. The size ML is designed for body sizes of up to 190 cm. The cover also serves as an ideal base for customized leather or textile wrappings. With its simple clamp system, it can be fitted quickly, minimizing the labor time required for the cosmetic finish.

<b>Length (mm)</b>	310-370
<b>Weight (g)</b>	151
<b>Body size (cm)</b>	170-190

<sup>1</sup> TF: transfemoral or above-knee



# Circleg One

## Cosmetic Cover TT

CC1-TT-KIT



### Lightweight and Customizable

The Circleg Cosmetic Cover TT<sup>2</sup> is designed for trans-tibial (below-knee) amputees and gives the Circleg its unique look. The cover provides a natural leg shape and maximum protection for your prosthesis. The lightweight material is impact, water and chemical resistant and can be adjusted in length and shape to suit the individual user. The cover is designed for body sizes of up to 170 cm. The cover also serves as an ideal base for customized leather or textile wrappings. With its simple clamp system, it can be fitted quickly, minimizing the labor time required for the cosmetic finish.

Length (mm)	250-310
Weight (g)	127
Body size (cm)	150-170

<sup>2</sup> TT: transtibial or below-knee

# How to order

We are happy to welcome you into the Circleg family! For ordering your desired components you can visit the ordering page on our website or contact us via email or phone.



[circleg.world/order](https://circleg.world/order)



[sales@circleg.world](mailto:sales@circleg.world)



+254 758 948096



PK1



PS1-KIT



CC1-TT-KIT



CC1-TF-SM-KIT



CC1-TF-ML-KIT



F1-S-KIT



F1-M-KIT



F1-L-KIT



I love the **energy**  
of the **Circleg!**

- Musoke Sulaiman



**Freedom of mobility  
for everyone.**

**circleg**